

JVC

SERVICE MANUAL

MULTI-CHANGER CONTROL RECEIVER

KS-RT75 A/C/J/U

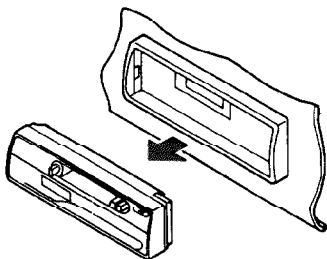
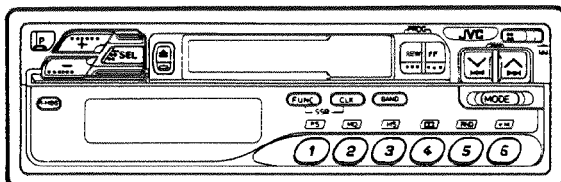

DIGIFINE

Area Suffix

A	Australia
C	Canada
J	U.S.A
U	Other areas

Contents

■ Features	Page2	6.Standard Schematic Diagram	26
■ Specifications	2	7.Location of P.C.Board parts	
■ Instructions(Extracts)	3	and Parts List	30
1.Location of Main Parts	14	8.Exploded View of Enclosure Component	
2.Removal of Main Parts	15	Parts and Parts List	38
3.Main Adjustment	18	9.Exploded View of Mechanism	
4.Wiring Connections	21	Component Parts and Parts List	40
5.Block Diagram	22	10.Packing Illustration and Parts List	Back Cover

6 Standard schematic diagram

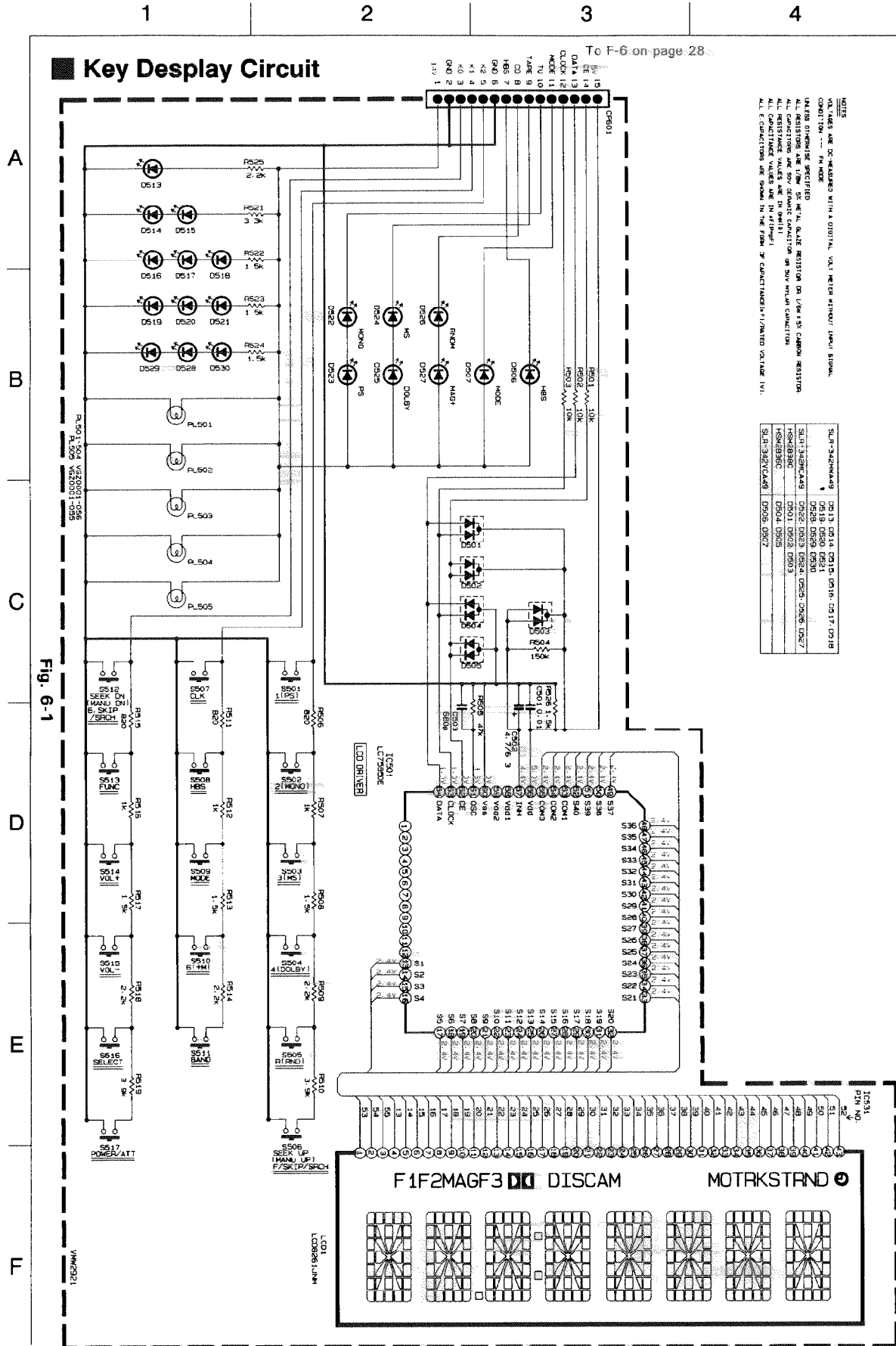

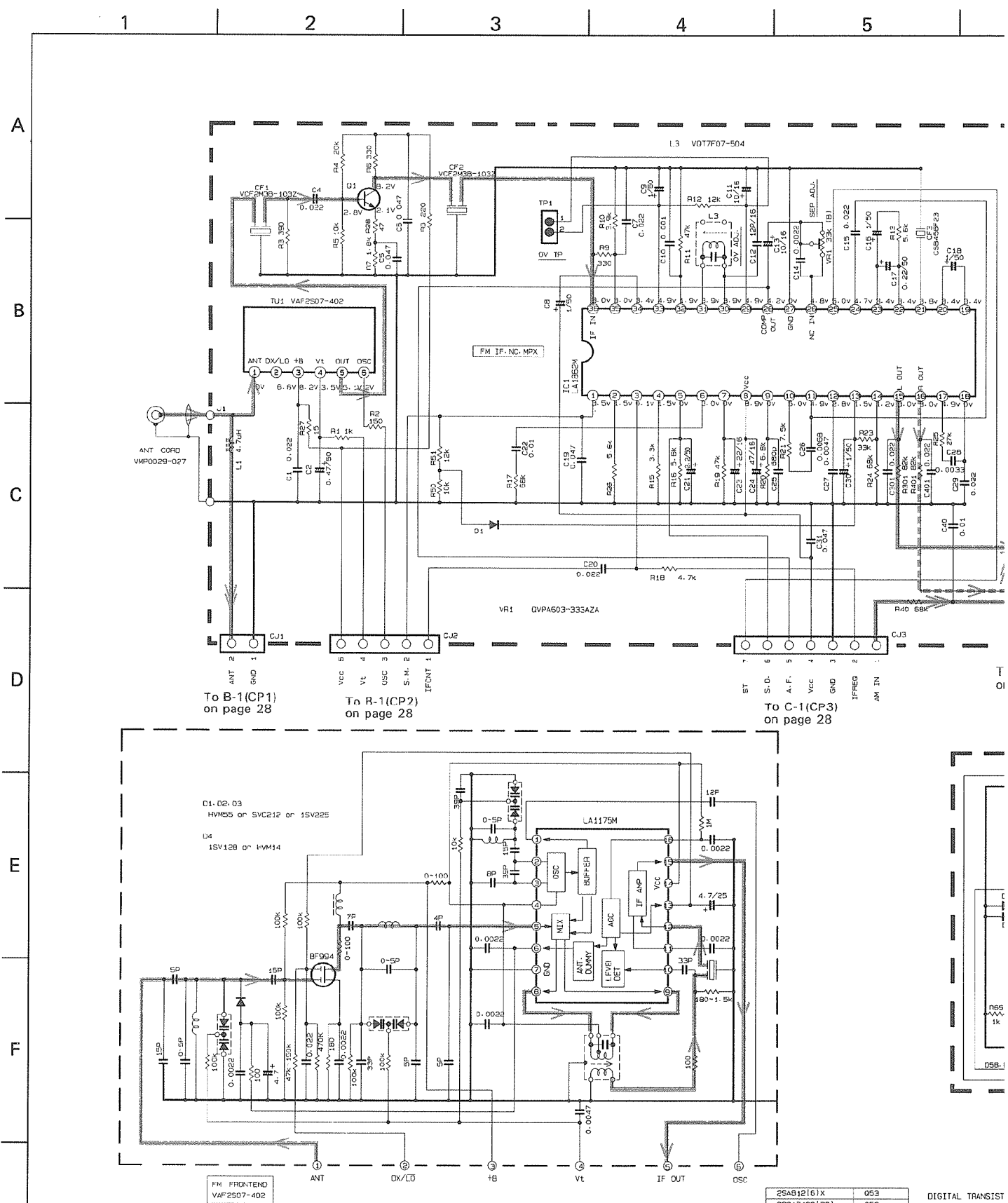

Note
VDH3499002TV

Fig. 6-2

25AB12161X	053
25C1740S1R5	052
25C28141F4F51TB	01
25K42751S.T.U1	031
FA1A4MX	0911

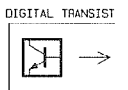

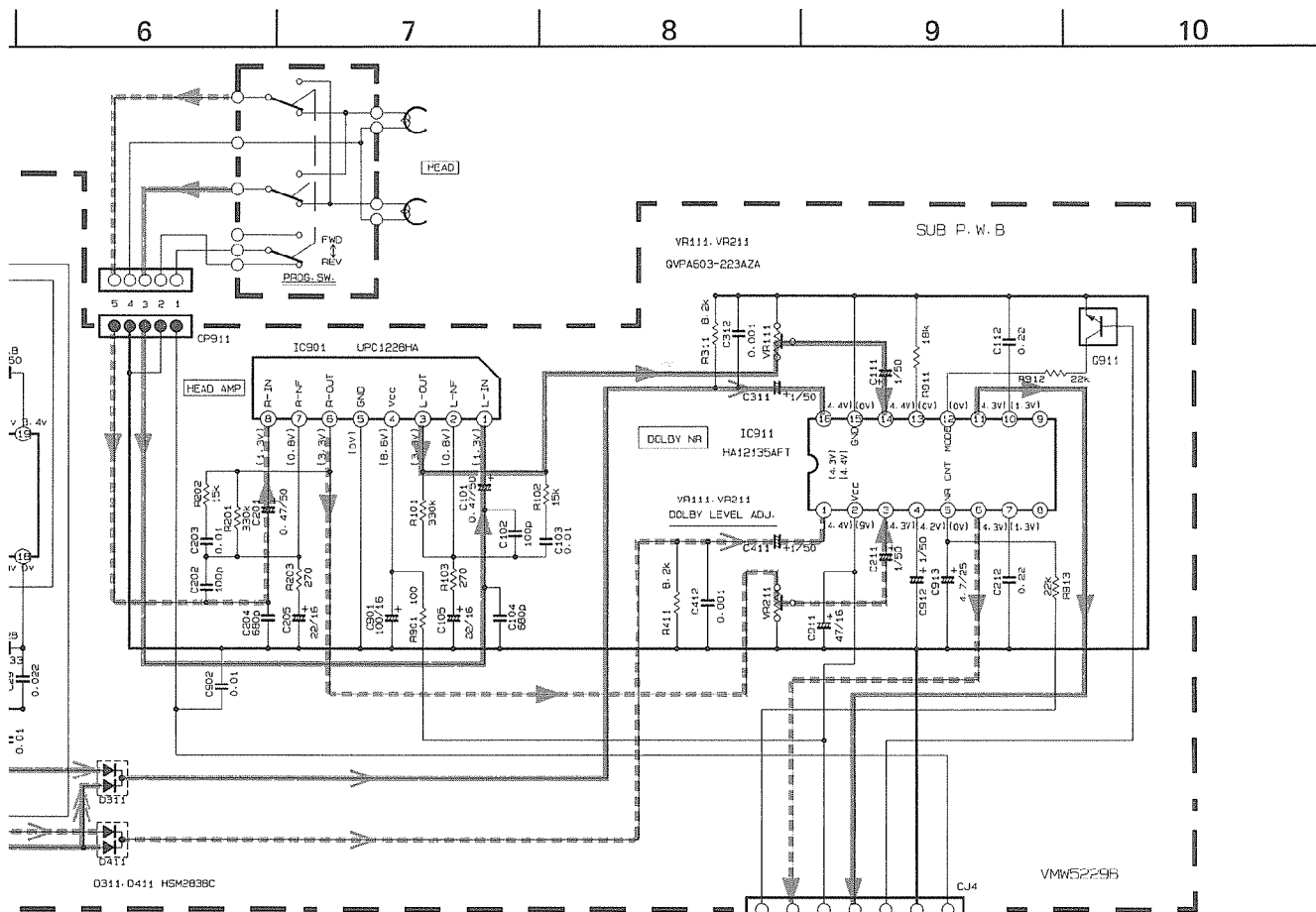

To D-1 on page 28

To E-1 on page 28

To D-1 on page 28

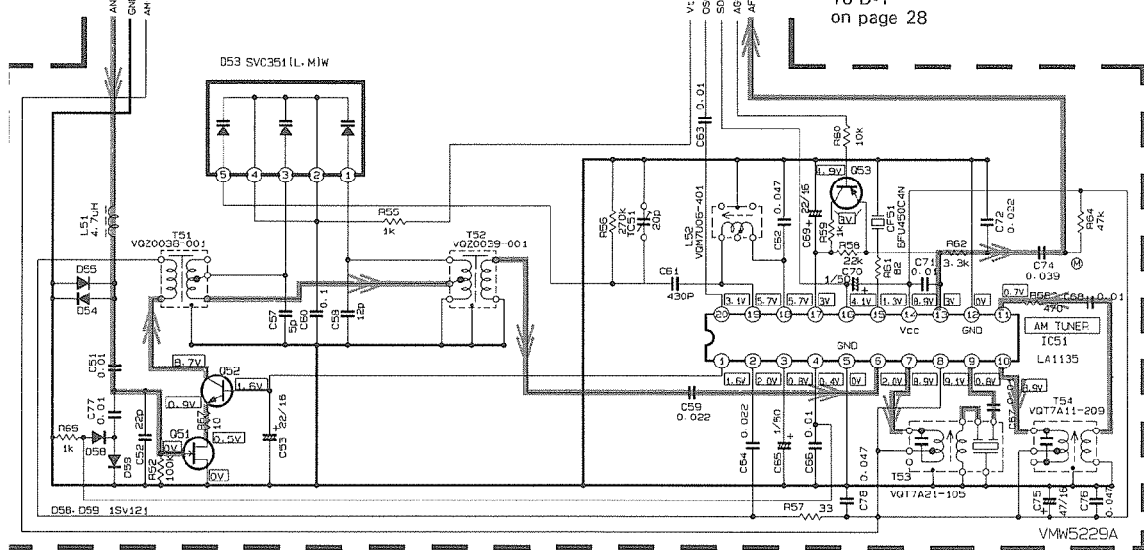

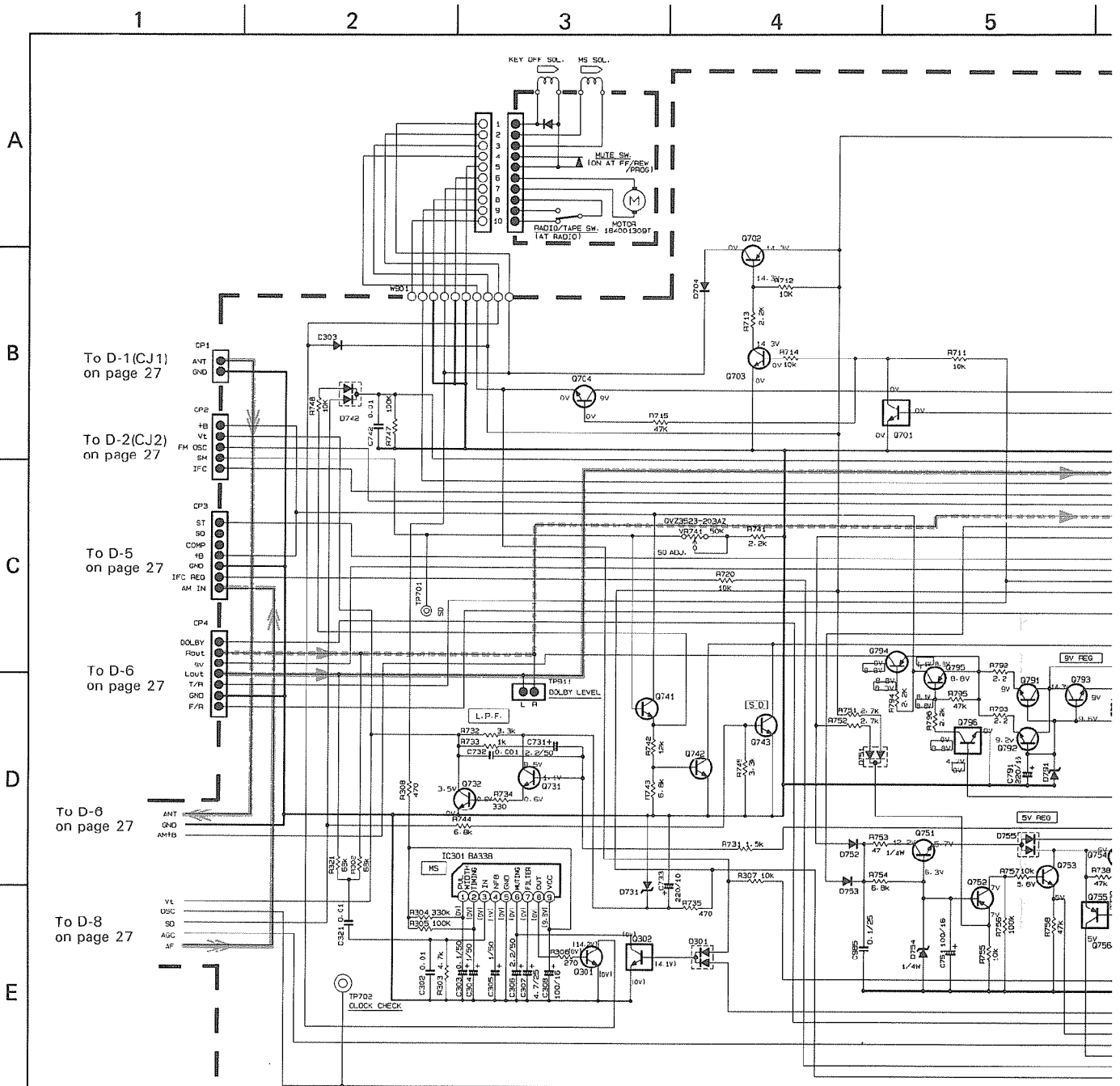

To D-1(CJ1) on page 27

To D-2(CJ2) on page 27

To D-5 on page 27

To D-6 on page 27

To D-6 on page 27

To D-8 on page 27

NOTES

1. VOLTAGES ARE DC-MEASURED WITH A DIGITVOLT METER WITHOUT "INFL" SIGNAL. CONDITION --- FM MODE □ AM MODE | TAPE MODE | CD MODE

2. UNLESS OTHERWISE SPECIFIED

ALL RESISTORS ARE 1/8W ±5% METAL GLAZE RESISTOR.

ALL CAPACITORS ARE 50V CERAMIC CAPACITOR OR 50V NYLON CAPACITOR.

ALL RESISTANCE VALUES ARE IN OHMS (Ω).

ALL CAPACITANCE VALUES ARE IN P.F.(PF).

ALL E. CAPACITORS ARE SHOWN IN THE FORM OF CAPACITANCE (μF)/RATED VOLTAGE (V).

ALL DIODES ARE 1SS133T OR MA16ES

Ⓢ 50V ±5% NYLON CAPACITOR OR 50V ±5% THIN FILM CAPACITOR

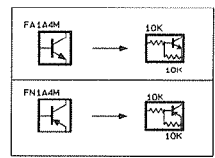

25C162(16)	0703-0704-0705-0707-0708-0709-0710-0731-0732-0741-0742-0743-0753
25D198A(1R.S)	0751-0791-0792-0793
25B132(1R.S)	0702-0794-0795
25A012(6)	0752-0754
25B105(10.R)	0301
FA1A0M	0302-0701-0758-0796
FN1A0M	0755-0961
DSK10C-E11	0303-0704-0752-0753
HSM2R3C	0301-0742-0751-0961
HSM2B3C	0755-0965
HZ10E31	0731-0791
H256-2E63	0754
H255-5E02	0601-0603-0604-0605-0606-0607-0701
1SS133T	0969

To A-3 on page 26

Note
VDH3499002CV

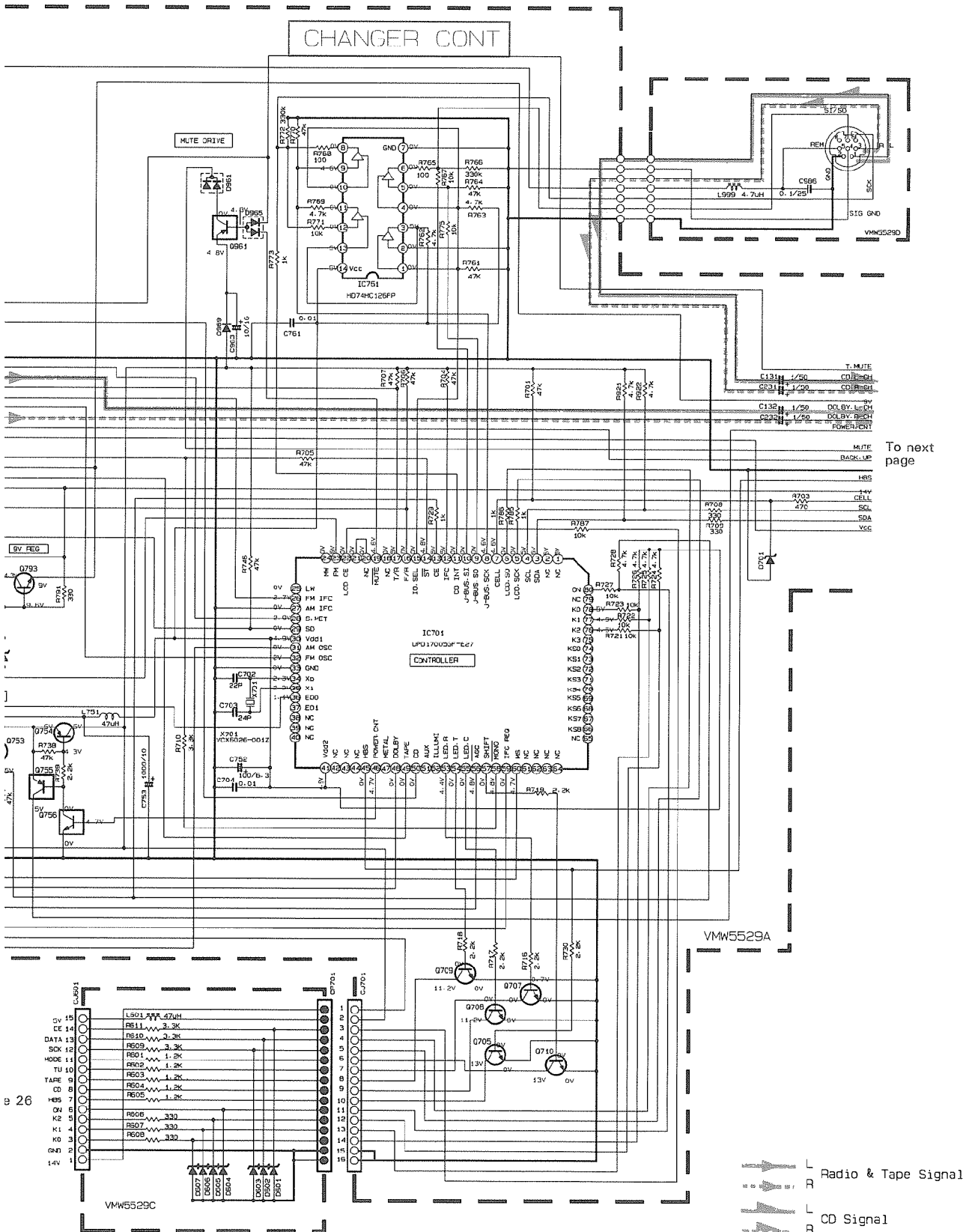

To next page

Fig. 6-3

To before page

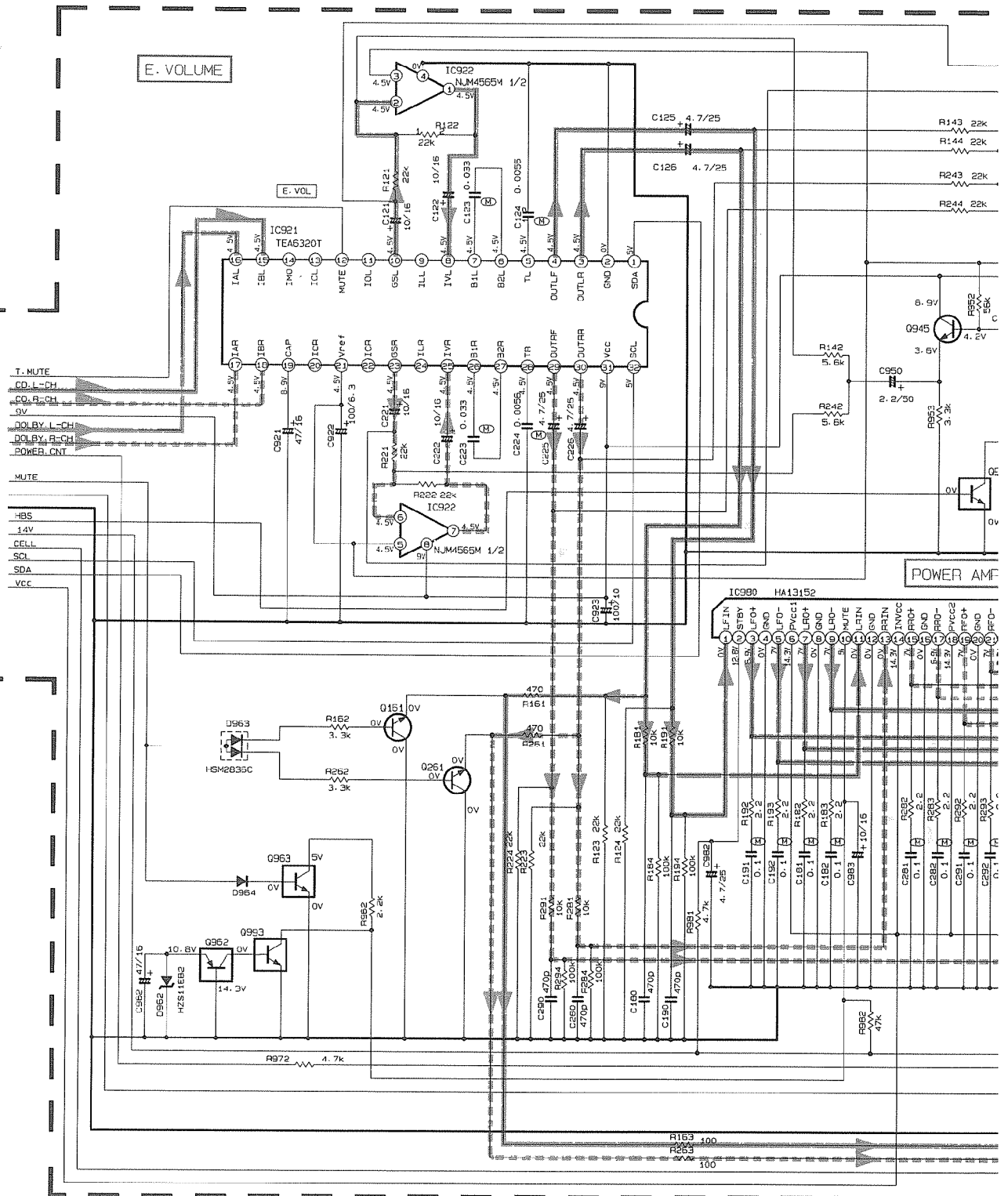

NOTES

- 1. VOLTAGES ARE DC-MEASURED WITH A DIGITAL VOLT METER WITHOUT INPUT SIGNAL.
CONDITION - - - FM MODE ; I TAPED MCE
- 2. UNLESS OTHERWISE SPECIFIED.
ALL RESISTORS ARE 1/8W 5% CARBON RESISTOR.
ALL CAPACITORS ARE 50V CERAMIC CAPACITOR.
ALL RESISTANCE VALUES ARE IN OHM(Ω).
ALL CAPACITANCE VALUES ARE IN nF(P=pF).
ALL E. CAPACITORS ARE SHOWN IN THE FORM OF CAPACITANCE(μ) / RATED VOLTAGE(V).
ALL DIODES ARE 1SS133T
Ⓜ - - - MYLAR CAPACITOR

2SC1623(16)	0941, 0942, 0943, 0945, 0971
2SD1048X-6	0161, 0261
FA1A4M	0944, 0963, 0993
FN1A4M	0962

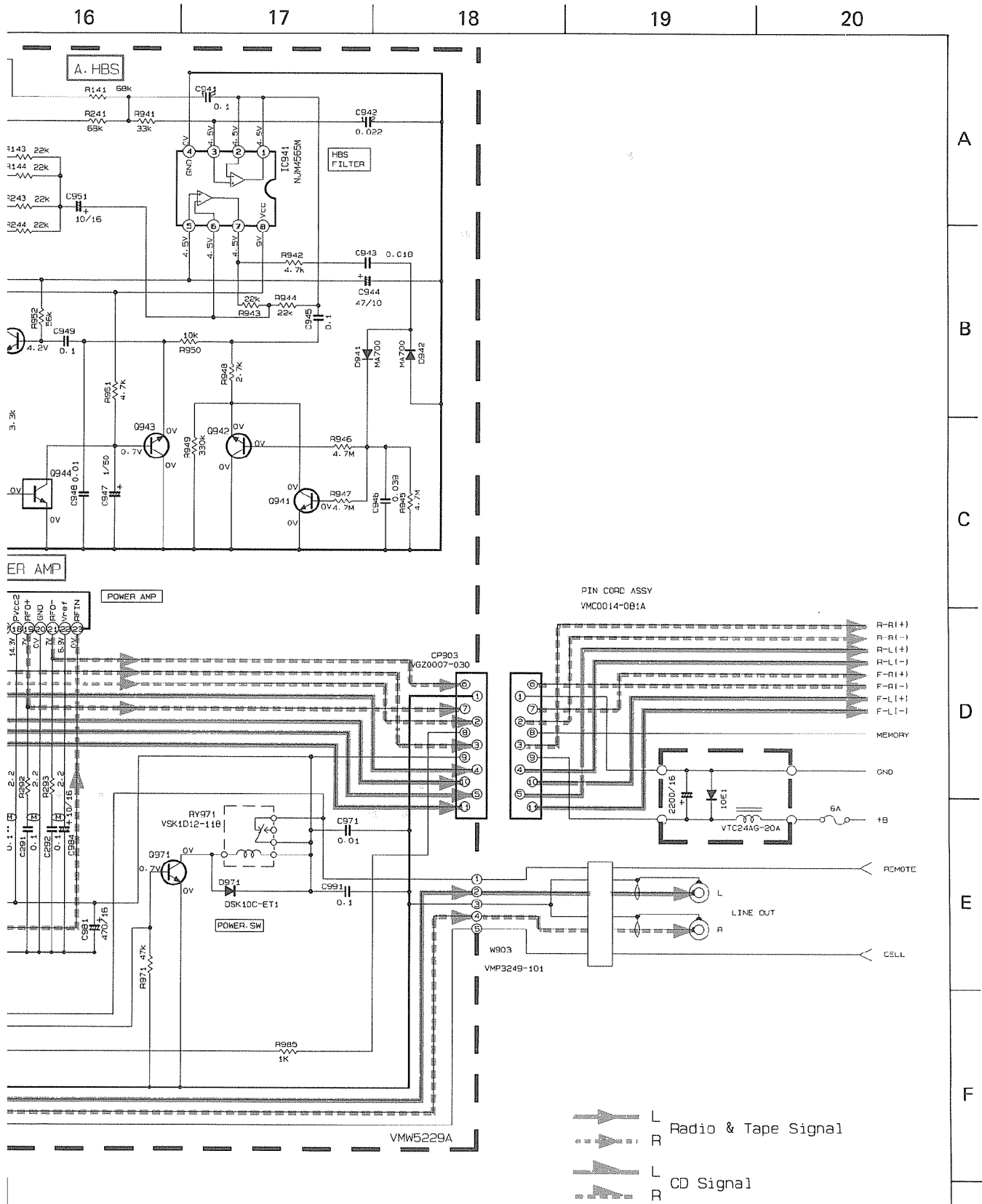

Fig. 6-4

This document was created with Win2PDF available at <http://www.daneprairie.com>.
The unregistered version of Win2PDF is for evaluation or non-commercial use only.